

CASE STUDY

Riviera Beach Redevelopment

Project: City of Riviera Beach – Redevelopment

Client: RB Community Redevelopment Authority

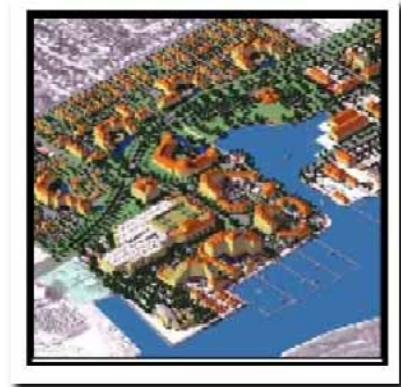

Scope: Celtic Energy was engaged as the Energy Efficiency/Sustainable Design Manager for the first sustainably designed whole community in America. Riviera Beach, Florida will see roughly \$3 billion worth of real estate development over the next ten years, and Celtic Energy will be there to guide the developers, architects, and builders through the LEED Green Building Certification Program, as well as the Energy Star Buildings Program, and EPA's Clean Cities Program (To reduce air pollution from transportation sources). We have begun working with the local utility FP&L, the Florida Solar Energy Center, and the Governor's Energy Office, in the first steps taken in the planning stages of this project.



Results: The first major accomplishment for Celtic Energy has been the development of a preliminary feasibility analysis for a 20,000 ton district chilled water plant, and a bio-mass fired cooling and power plant. Celtic Energy will be conducting a detailed engineering and economic analysis of the various options analyzed in the preliminary study, as well as finalizing the plans for incorporating sustainable design features into each of the redevelopment projects. Celtic Energy has written guidelines that incentivize developers to meet LEED criteria as part of their proposals, and eventual construction.

Customer Contact: Dr. James Baugh, PhD
Executive Director
Riviera Beach Community Redevelopment Authority
2100 Broadway, Suite 300
Riviera Beach, FL
(561) 889-3790



Celtic Energy, INC. • 701 Hebron Avenue, Glastonbury, CT 06033
• 860.882.1515 • or contact us at: megan@celticenergy.com

